



CHATTERTON | REES



91a Clapham Common North Side

, London, SW4 9SG

£1,435,000



# 91a Clapham Common North Side



## Description

An impressive split-level apartment set across the ground and lower ground floors of this handsome Victorian building, with far-reaching views over Clapham Common. Extending to approximately 1500 sq ft, the property offers excellent proportions, high ceilings and an abundance of natural light throughout.

The ground floor features a beautifully presented reception room to the front, with a bay window, wooden flooring and bespoke cabinetry. To the rear, a stylish kitchen/dining room is fitted with shaker-style units, integrated appliances and a central island, with sliding doors opening onto a private patio garden, ideal for entertaining. The garden also benefits from rear access onto Stormont Road. A separate WC completes this level.

The lower ground floor comprises three double bedrooms. The principal suite offers a walk-in wardrobe, en suite shower room and access to a private lightwell. Two further bedrooms, both with built-in storage, are served by a family bathroom.

- Three Bedrooms
- Split Level
- Excellent Condition
- Share Of Freehold
- Private Garden
- High Ceilings
- Common Views
- Close to Transport





## Floor Plan

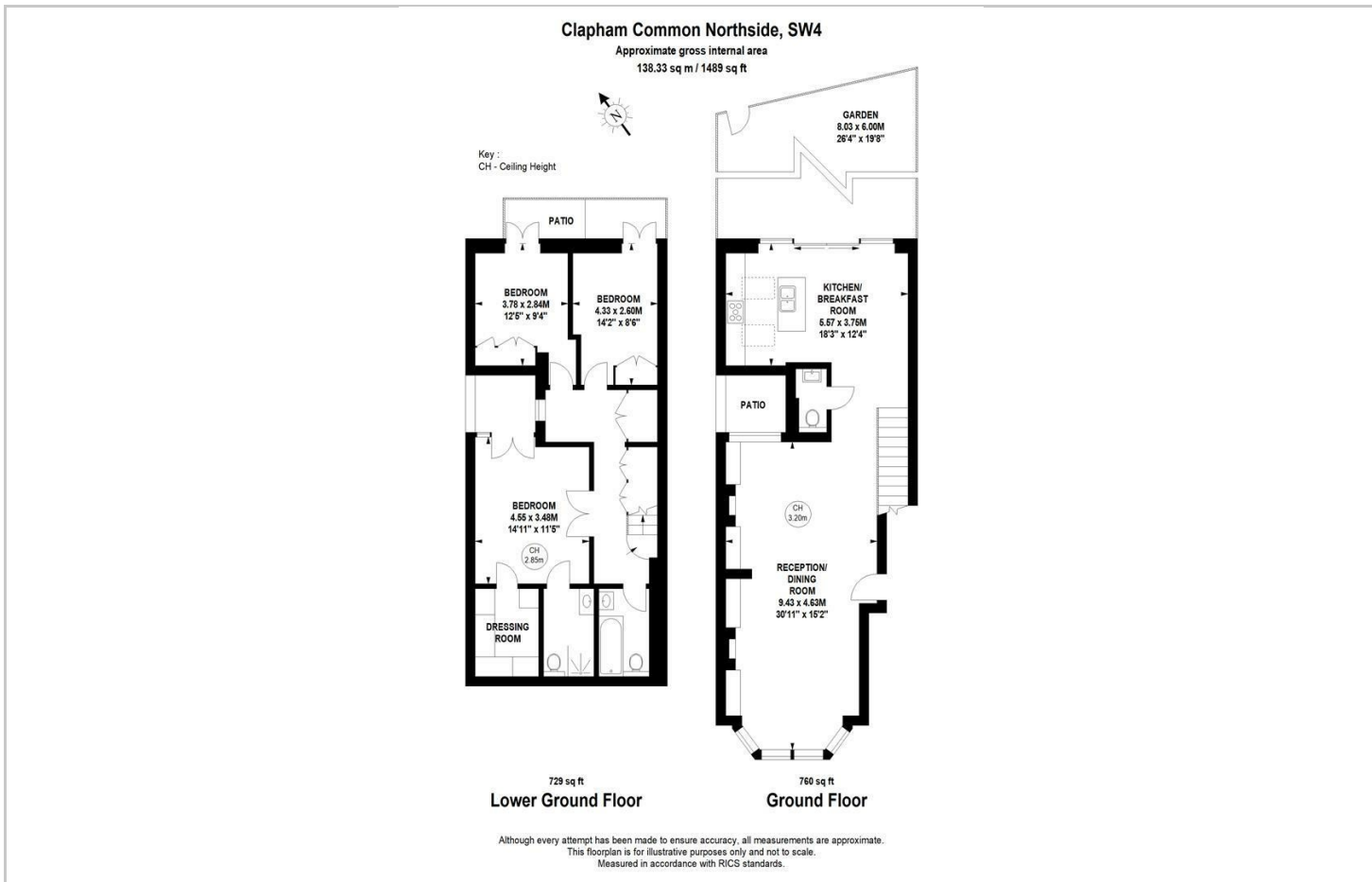

## Area Map

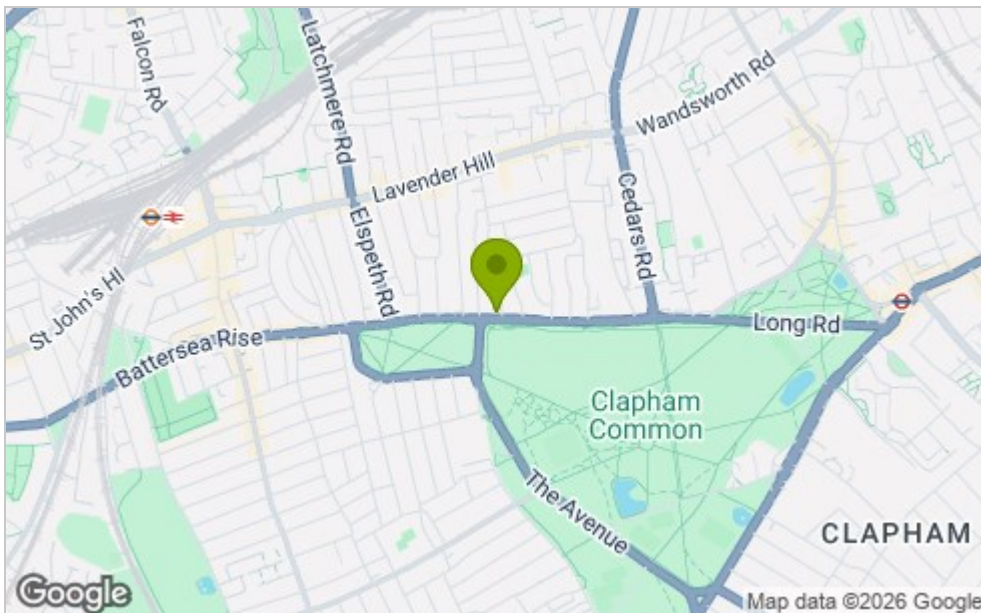

## Viewing

Please contact our Chatterton Rees Office on 020 3780 0580 if you wish to arrange a viewing appointment for this property or require further information.

These particulars, whilst believed to be accurate are set out as a general outline only for guidance and do not constitute any part of an offer or contract. Intending purchasers should not rely on them as statements of representation of fact, but must satisfy themselves by inspection or otherwise as to their accuracy. No person in this firm's employment has the authority to make or give any representation or warranty in respect of the property.

## Energy Efficiency Graph

